



## SPECIFICATION FOR APPROVAL

Customer: Customer  
Model No: KMR2A18049HB-P  
Motor Type: External rotor AC motor

**Model: KMR2A18049HB-P****Motor: External rotor AC motor****1. General Characters**

1-1	Rated Voltage	230 VAC
1-2	Frequency	50/60 Hz
1-3	Operating Voltage	200~242 VAC
1-4	Capacitor	1.5 $\mu$ F/500 VAC
1-5	Rated Speed	2550/2850 RPM
1-6	Input Current	0.24/0.32 A
1-7	Input Power	52/66 W
1-8	Air Flow	430/480 m <sup>3</sup> /H
1-9	Static Pressure	320/380 Pa
1-10	Acoustical Noise	63/66 dB(A)
1-11	Life Expectance	30,000 Hours At nominal supply voltage, full speed room temperature 20°C.
1-12	Direction of Rotation	Clockwise seen on rotor
1-13	Insulation Class	Class F
1-14	Protection Type	IP44
1-15	Thermal Protection	Cut off temperature: 150-160°C; replacement temperature: 100-130°C.

**2. Mechanical Characters**

2-1	Dimension	See dimension drawing
2-2	Material of Impeller	PA66
2-3	Impeller Plate	PA66
2-4	Mounting Position	Any
2-5	Surface of Rotor	Coated in black
2-6	Bearing System	Ball bearing

## Model: KMR2A18049HB-P

Motor: External rotor AC motor

### 3. Environmental Characters

3-1	Operating Temperature	-30°C to 60°C
3-2	Storage Temperature	-10°C to 40°C
3-3	Operating Humidity	0% to 95% RH
3-4	Storage Humidity	0% to 75% RH
3-5	Dustproof Test	Temperature range: 15°C to 35°C. 1mm diameter metal wire cannot go through the gap between rotor cup and base. Follow IEC 60529 IP4X.
3-6	Waterproof Test	Temperature range: 15°C to 35°C and duration of test: at least 10 minutes, to spray water from all direction (360°). Follow IEC 60529 IPX4
3-7	RoHS	All the material meets RoHS standard.

### 4. Performance Curve

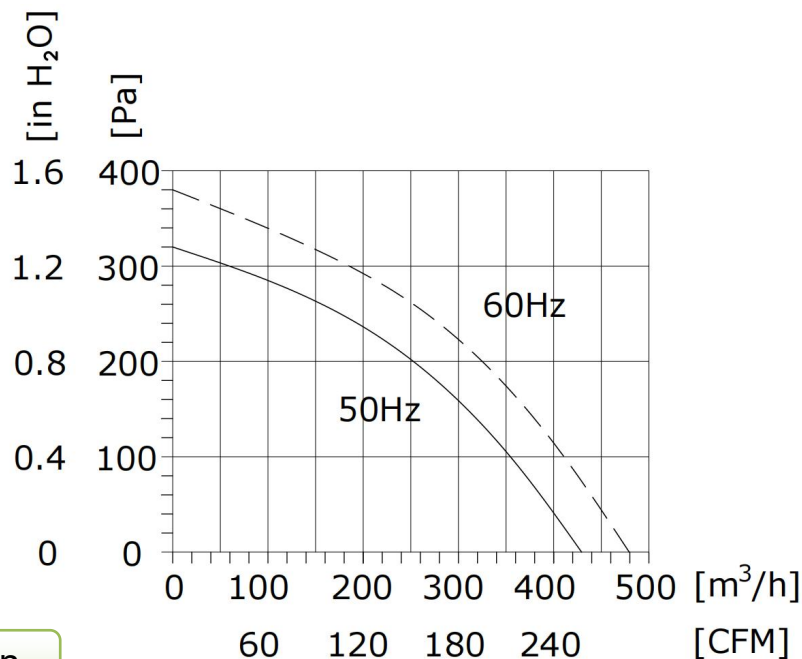

#### Testing Condition

Input Voltage----Operating voltage (230V-50/60 Hz)  
 Temperature-----Room temperature  
 Humidity-----65%RH

## Model: KMR2A18049HB-P

Motor: External rotor AC motor

### 5. Outline Drawing

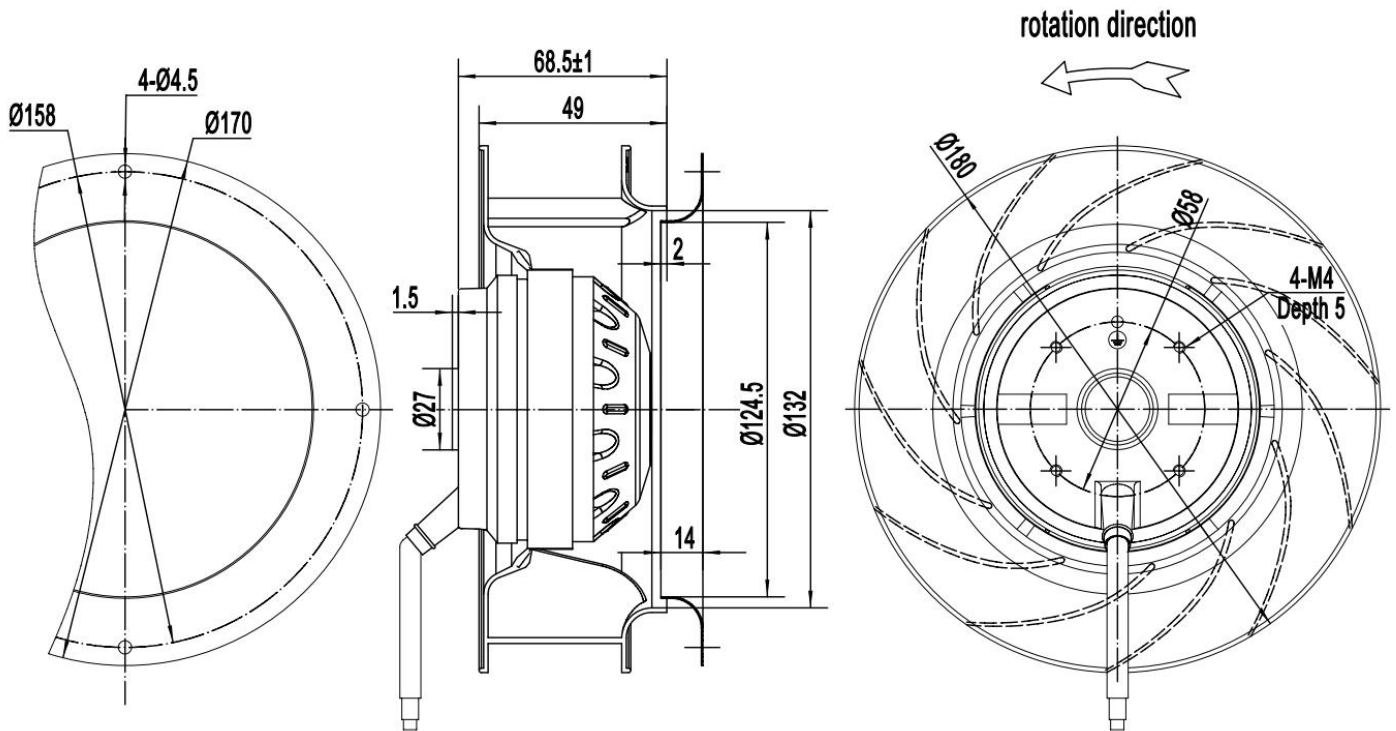

### 6. Connection Diagram

## Connection Diagram

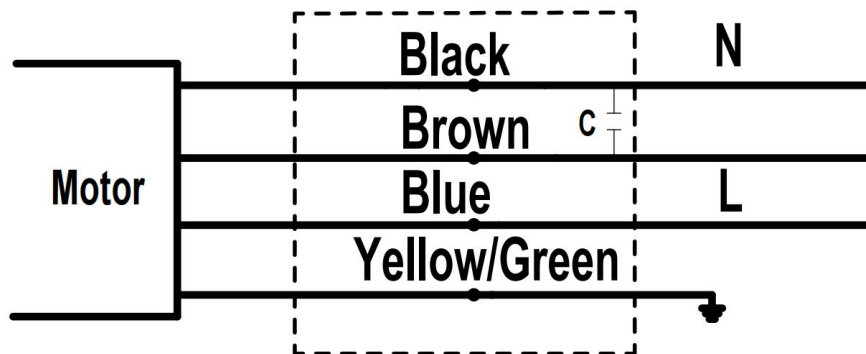

**Model:**  
**KMR2A18049HB-PMotor:**  
**External rotor AC motor**

## **7. Safety Requirements**

1. Make sure that the metal casing of the stator connected to the ground before being powered on.
2. Fan needs a few seconds to start after being powered on. To prevent personal injury, do not touch the impellers or rotor when the power is on or in a low speed.
3. Unless they are instructed by the person(s) responsible for their safety, those who are lack of physical, mental or sensory capacities and proper practical experience or expertise cannot use this appliance. Please do not let the children play with this product.
4. If the power cord be damaged, the power cord must be replaced by the manufacturer in order to avoid accident of the proxy service personnel or the equivalent qualification maintenance personnel.
5. Please carefully read this technical specification before using the product.