

风扇 / FAN

KM4028S-E100-L



产品参数 / Product Parameters

扇叶 / Impeller: PBT塑料制/Made of plastic PBT, 阻燃等级UL 94 V-0

机框 / Frame: PBT塑料制/Made of plastic PBT, 阻燃等级UL 94 V-0

外观尺寸 / Dimensions

Unit: mm

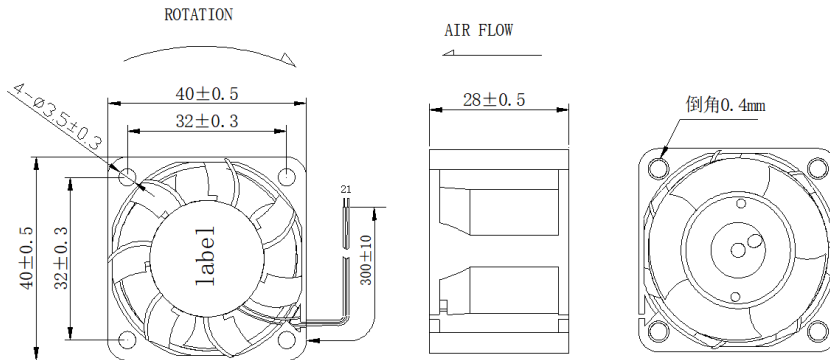

NOTES:

1. UNIT:mm
2. LEAD WIRE: UL1007# 26AWG 分线
PIN 1:BLACK WIRE -----(-)
PIN 2:RED WIRE -----(+)
3. HOUSING: NP
4. THIS PRODUCT IS RoHS COMPLIANT

技术数据 / Technical Data

型号 Model	额定电压 Rated Voltage	电压范围 Voltage Range	启动电压 Starting Voltage	额定电流 Rated Current	消耗功率 Rated Power	额定转速 Rated Speed	最大风量 Max. Air Flow	最大静压 Max. Static Pressure	噪音 Noise Level
	V	V	V	A	W	rpm	cfm	mmH ₂ O	dB(A)
KM4028S-E100-L	DC 12	7 ~ 13.2	7	0.17	2.04 (MAX:2.4)	10000 ± 10%	13.1	15.9	38.9

轴承类型 Bearing system	保存温度范围 Storage Temperature Range	保存湿度范围 Storage Humidity Range	工作温度范围 Operating Temperature Range	工作湿度范围 Operating Humidity Range	寿命 Life Expectancy [MTTF]
滚珠 BALL	-40°C ~ 70°C	15% ~ 65%RH	-10°C ~ 70°C	15% ~ 65%RH	70'000H [40°C]

曲线图 / Curves

